

BI-TELECENTRIC LENS FOR DETECTORS UP TO 2/3"



Model:	TC 23 96	
Magnification (X):	0,093 +/- 3%	
Object Field (mm):	1/4" (3,6 x 2,7):	38,5 x 28,9
	1/3" (4,8 x 3,6):	51,4 x 38,5
	1/2" (6,4 x 4,8):	68,5 x 51,4
	1/1.8" (7,13 x 5,37):	76,3 x 57,5
	2/3" (8,8 x 6,6):	94,2 x 70,7
Working Distance (mm):	279,6 +/- 8	
Working F-number:	8	
MTF @70 lp/mm (%):	> 40	
Field Depth (mm):	70,0 @ F/ 8	
Image side N.A.:	0,062	
Object side N.A.:	0,006	
Telecentricity (degree):	< 0,08	
Distortion (%):	<0,08	
Mount:	C	
Length (mm):	337	
Maximum external diameter (mm):	143	
Weigh (g):	2500	

ACCESSORIES AND OPTIONS:



Collimated/Telecentric illumination:
compatible with LTCL96 illuminator;
green light suggested.



Coaxial illumination:
not available.



Back Light illumination:
compatible with LTBK64 illuminator.



Clamping Mechanics:
compatible with Teleclamp96.



Direct illumination:
not available.



Filters:
filters can be inserted in the rear part
of the lens, by means of TC Filter Kit.

Rev No.	Description	Date	Name
A	First light	01/05/03	A.Vismara
D	Redesign	15/02/06	A.Vismara

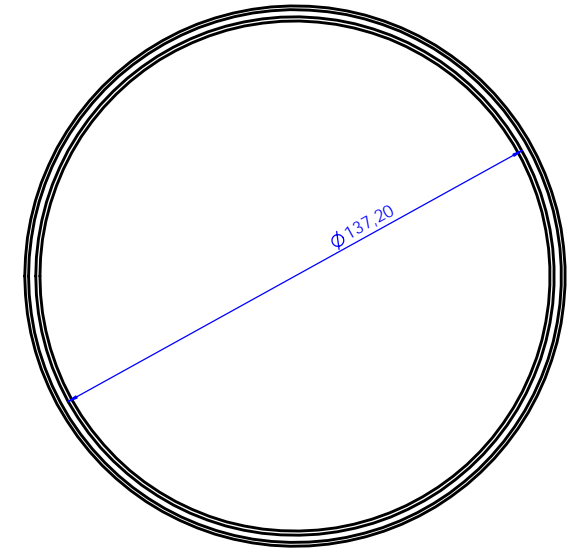
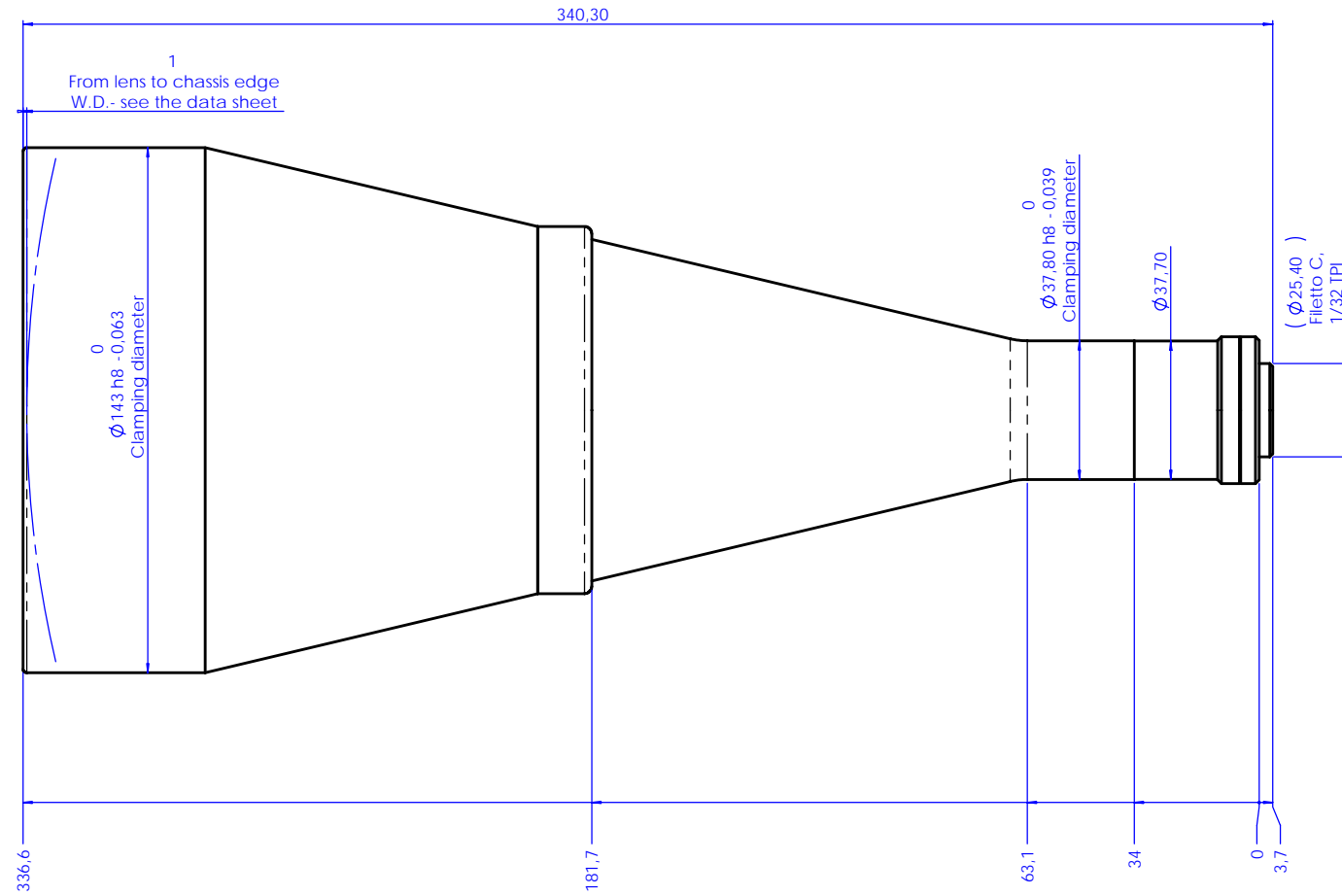

Material	N.A.	Mass	2.5 kg	Scale	1:1
Surface treatment	N.A.	Project-Prod.Item/Instrument		Telecentric lens 23 96	
Geometrical tolerance (ISO 2768-2)		Class	K	Undimensioned Bevels	1x45°
Linear tolerance (ISO 2768-2)		Class	m	Undimensioned radii	R 0.5
0.5	>3-	>6-	>30-	>120-	>400-
>3	6	30	120	400	1000
±0.1	±0.1	±0.2	±0.3	±0.5	±0.8
					±1.2
www.opto-engineering.com		Date	Name		
Designed		15/02/06	A.Vismara		
Draw		15/02/06	A.Vismara		
Checked		x	C.Sedazzari		
Drawing No.		02201-0-D			
Sheet		1/1			
Reproduction forbidden without specific authorization					
OPTO ENGINEERING S.r.l. - 46100 Mantova Italy - Via Cremona, 28 - Tel/fax +39 0376 229585 - e-mail info@opto-engineering.com - http://www.opto-engineering.com					