

BI-TELECENTRIC LENS FOR DETECTORS UP TO 1/2"



Part Number	TC 12 80	
Magnification		0,080 +/- 3%
Field Of View	(mm x mm)	
with 1/4" (3,6 x 2,7) detector		44,8 x 33,6
with 1/3" (4,8 x 3,6) detector		59,8 x 44,8
with 1/2" (6,4 x 4,8) detector		79,7 x 59,8
with 1/1.8" (7,13 x 5,37) detector		88,8 x 66,8
with 2/3" (8,8 x 6,6) detector		diam. = 82,2
Working Distance	(mm)	227,7 +/- 7
Working F-number		8
Telecentricity	(degree)	< 0,08
Distortion	(%)	<0,1
Field Depth	(mm)	104,0
CTF @70 lp/mm	(%)	> 50
Image side N.A.		0,0620
Object side N.A.		0,0050
Mount		C
Length	(mm)	271,6
External diameter	(mm)	116,0
Weight	(g)	1560

Possible vignetting at the image corners with 1/1.8" detectors

ACCESSORIES AND OPTIONS:



Collimated/Telecentric illumination:
compatible with LTCL80 illuminator;
green light suggested.



Coaxial illumination:
compatible with LTCX64 illuminator.



Back Light illumination:
compatible with LTBK64 and LTBK80
illuminators.



Clamping Mechanics:
compatible with CMH080.



Direct illumination:
compatible with LTRN64 diffusive
annular illuminator.



Filters:
filters can be inserted in the rear part
of the lens, by means of TC Filter Kit.

Rev No.	Description	Date	Name
A	First light	10/05/06	A.Vismara

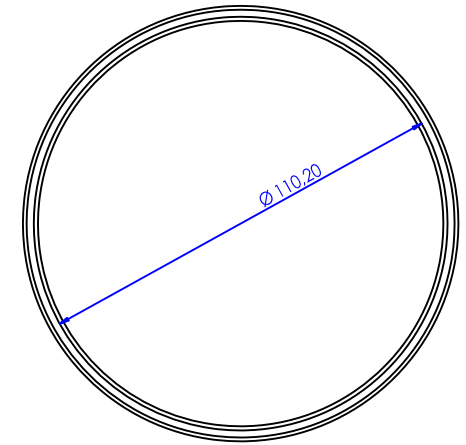
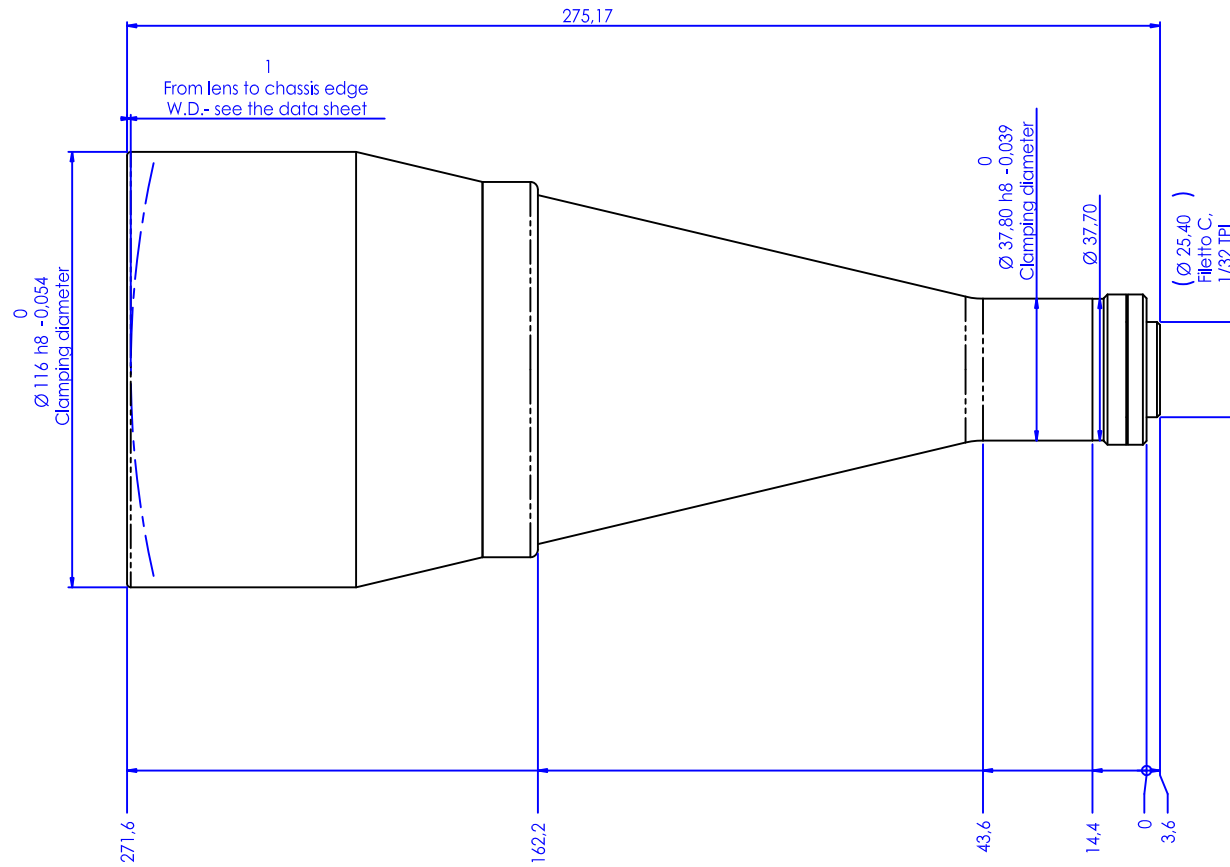

Material	N.A.		Mass	1.56 kg	Scale	1:1
Surface treatment	N.A.		Project-Prod Item/Instrument	Telecentric lens 12 80		
Geometrical tolerance (ISO 2768-2)	Class	K	Indimensioned bevels	1x45°	Description	
Linear tolerance (ISO 2768-2)	Class	m	Indimensioned radii	R 0.5	Assembly	
±0.1	±0.1	±0.2	±0.3	±0.5	±0.8	±1.2
±3	6	30	120	400	1000	±2000
±4000	±10000	±20000	±40000	±100000	±200000	±500000
www.opto-engineering.com			Date	10/05/06	Name	A.Vismara
Designed			Date	10/05/06	Name	A.Vismara
Drawn			Date	10/05/06	Name	A.Vismara
Checked			Date	10/05/06	Name	C.Sedazzari
DTPD ENGINEERING S.r.l. - 46100 Mantova Italy - Via Cromona, 28 - Tel/Fax +39 0376 229565 - e-mail: info@opto-engineering.com - http://www.opto-engineering.com			Drawing No.	02421-0-A		Sheet 1/1
Reproduction forbidden without specific authorization						