

BI-TELECENTRIC LENS FOR DETECTORS UP TO 1/2"



Part Number	TC 12 24	
Magnification		0,255 +/- 3%
Field Of View	(mm x mm)	
with 1/4" (3,6 x 2,7) detector		14,1 x 10,6
with 1/3" (4,8 x 3,6) detector		18,8 x 14,1
with 1/2" (6,4 x 4,8) detector		25,1 x 18,8
with 1/1.8" (7,13 x 5,37) detector		28,0 x 21,1
with 2/3" (8,8 x 6,6) detector		diam. = 25,9
Working Distance	(mm)	69,2 +/- 2
Working F-number		8
Telecentricity	(degree)	< 0,1
Distortion	(%)	< 0,08
Field Depth	(mm)	10,0
CTF @70 lp/mm	(%)	> 45
Image side N.A.		0,0620
Object side N.A.		0,0160
Mount		C
Length	(mm)	117,8
External diameter	(mm)	44,0
Weight	(g)	370

Possible vignetting at the image corners with 1/1.8" detectors

ACCESSORIES AND OPTIONS:



Collimated/Telecentric illumination:
compatible with LTCL24 illuminator;
green light suggested.



Coaxial illumination:
not available.



Back Light illumination:
Compatible with LTBK36 and LTBK48
illuminators.



Clamping Mechanics:
compatible with CMHO24.



Direct illumination:
compatible with LTRN36 diffusive
anular illuminators.



Filters:
filters can be inserted in the rear part
of the lens, by means of TC Filter Kit.

Rev No.	Description	Date	Name
A	First light	01/05/03	A.Vismara
D	Redesign	19/07/06	A.Vismara
E	Length of C thread	12/01/09	A.Vismara

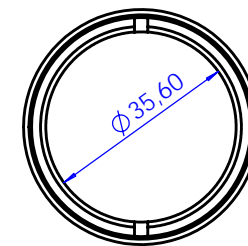
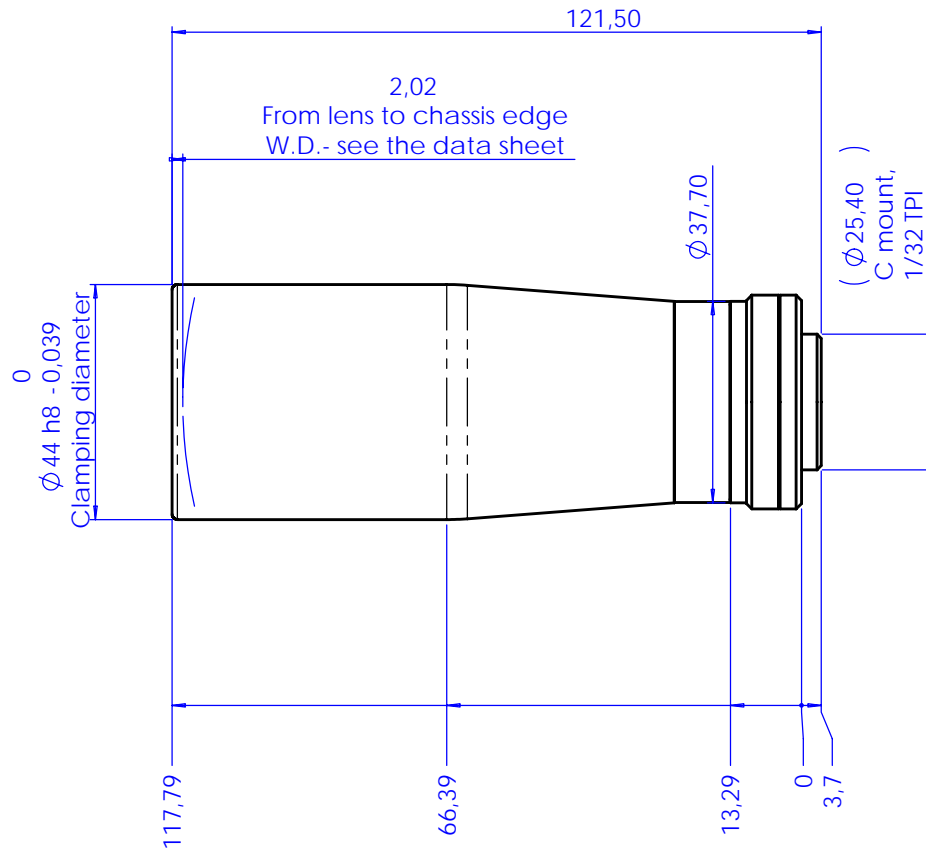

Material	N.A.			Mass	0.37 kg	Scale	1:1
Surface treatment	N.A.			Project-Prod.Item/Instrument Telecentric lens 12 24			
Geometrical tolerance (ISO 2768-2)			Class	K	Description		
Linear tolerance (ISO 2768-2)			Class	m	Undimensioned bevels	1x45°	Assembly
0.5	>3-	>6-	>30-	>120	>400-	>1000	
+3	6	30	120	+400	+1000	+2000	R 0.5
±0.1	±0.1	±0.2	±0.3	±0.5	±0.8	±1.2	±2
www.opto-engineering.com			Date	Name	Drawing No.		
			Designed	19/07/06	A.Vismara	01551-0-E	
			Draw	12/01/09	A.Vismara	Sheet	
			Checked	X	C. Sedazzari	1/1	
OPTO ENGINEERING S.r.l. - 46100 Mantova Italy - Via Cremona, 29/2 - Tel. +39 0376 229585 - e-mai: info@opto-engineering.com - http://www.opto-engineering.com							