

TC 12 120

BI-TELECENTRIC LENS FOR DETECTORS UP TO 1/2"



Part Number		TC 12 120
Magnification		0,052 +/- 3%
Field Of View	(mm x mm)	
with 1/4" (3,6 x 2,7) detector		69,1 x 51,8
with 1/3" (4,8 x 3,6) detector		92,1 x 69,1
with 1/2" (6,4 x 4,8) detector		122,8 x 92,1
with 1/1.8" (7,13 x 5,37) detector		136,7 x 103,0
with 2/3" (8,8 x 6,6) detector		diam. x 126,6
Working Distance	(mm)	336,5 +/- 10
Working F-number		8
Telecentricity	(degree)	< 0,08
Distortion	(%)	<0,1
Field Depth	(mm)	247,0
CTF @70 lp/mm	(%)	> 45
Image side N.A.		0,0620
Object side N.A.		0,0032
Mount		C
Length	(mm)	402,7
External diameter	(mm)	180,0
Weight	(g)	5300

Possible vignetting at the image corners with 1/1.8" detectors

ACCESSORIES AND OPTIONS:



Collimated/Telecentric illumination:
compatible with LTCL120 illuminator;
green light suggested.



Coaxial illumination:
not available.



Back Light illumination:
compatible with LTBK192 illuminator.



Clamping Mechanics:
use the built-in holed flange to mount
the lens.



Direct illumination:
not available.



Filters:
filters can be inserted in the rear part
of the lens, by means of TC Filter Kit.

Rev No.	Description	Date	Name
A	First light	26/05/06	A.Vismara

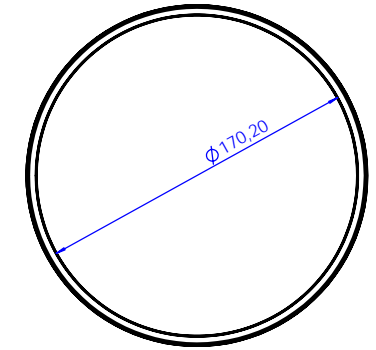
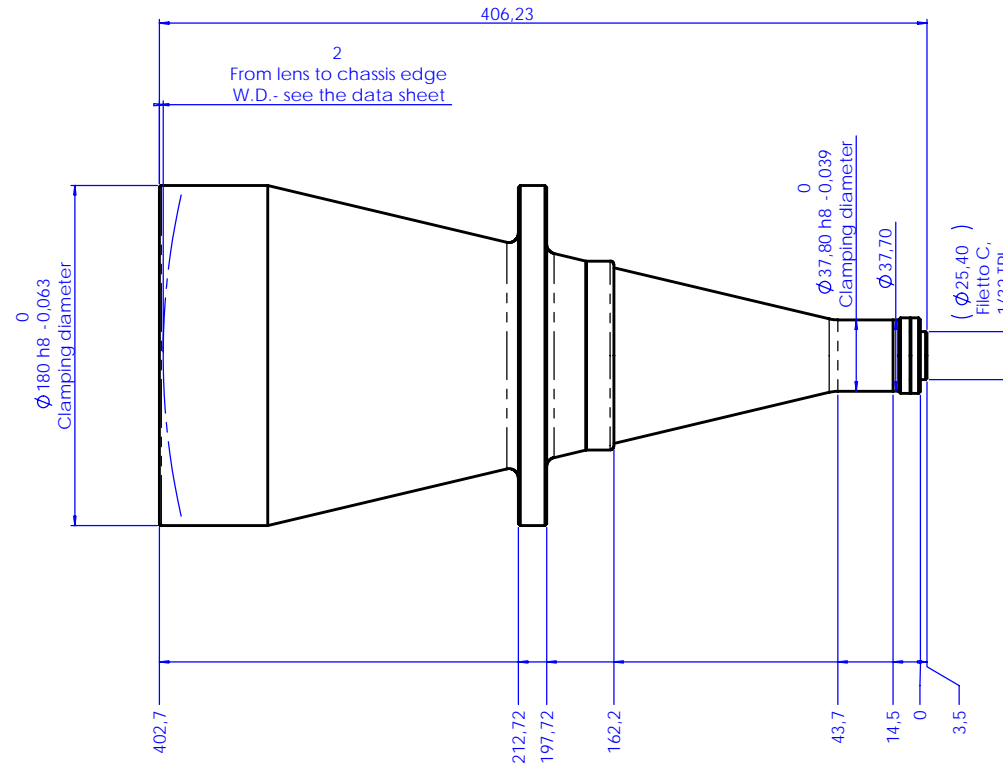
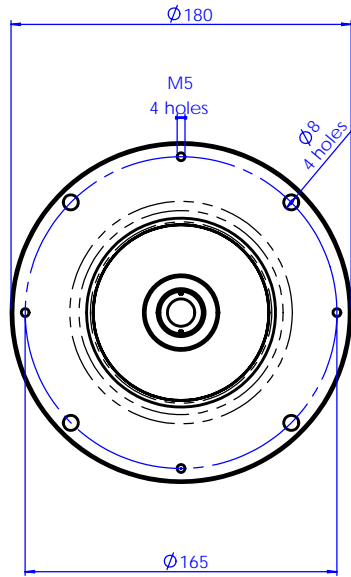

Material	N.A.	Mass	5.3 kg	Scale	1:2
Surface treatment	N.A.	Project-Prod.Item/Instrument	Telecentric lens 12 120		
Geometrical tolerance (ISO 2768-2)		Class	K	Undimensioned Bevels	1x45°
Linear tolerance (ISO 2768-2)		Class	m	Undimensioned Radii	R 0.5
0.5	>3-	>6-	>30-	>120-	>400-
-3	6	30	120	400	1000
±0.1	±0.1	±0.2	±0.3	±0.5	±0.8
		Class	m	±1.2	±2
www.opto-engineering.com		Date	Name	Drawing No.	Sheet
Designed		26/05/06	A.Vismara	02521-0-A	1/1
Draw		26/05/06	A.Vismara		
Checked		x	C.Sedazzari		
Reproduction forbidden without specific authorization					
OPTO ENGINEERING S.r.l. - 46100 Mantova Italy - Via Cremona, 28 - Tel/Fax +39 0376 229585 - e-mail: info@opto-engineering.com - http://www.opto-engineering.com					