

**LT CL 96**

# Collimated Illuminator



part number	LT CL 96/X	
<b>Beam Diameter</b>	(mm)	120,0
<b>Available Colours</b>		
/R (red)		x
/G (green)		x
/B (blue)		x
/W (white)		x
/IR890 (IR, peak 890 nm)		x
/IR940 (IR, peak 940 nm)		
<b>Length</b>	(mm)	309,6
<b>Outer Diameter</b>	(mm)	143,0
<b>Compatible Telecentric Lenses</b>		
	TC 13	96
	TC 12	96
	TC 23	85, 96
	TC 4M	85, 96
	TC 2M	96
	TC16M	96
<b>DEVICE POWER RATINGS</b>		
DC Voltage	(volt)	12 to 24
Power Consumption	(watt)	< 2 watt
<b>LED DIRECT DRIVE RATINGS</b>		
<b>for /W, /B and /G versions</b>		
Max Forward DC Voltage	(volt)	3,5
Max Forward Current	(mA)	350
<b>for /R version</b>		
Max Forward DC Voltage	(volt)	2,5
Max Forward Current	(mA)	350
<b>for /IR890 and /IR940 versions</b>		
Max Forward DC Voltage	(volt)	1,6
Max Forward Current	(mA)	500 mA

Rev No.	Description	Date	Name
D	First light	07/06/06	A.Vismara
E	New LED holder	10/05/08	A.Vismara

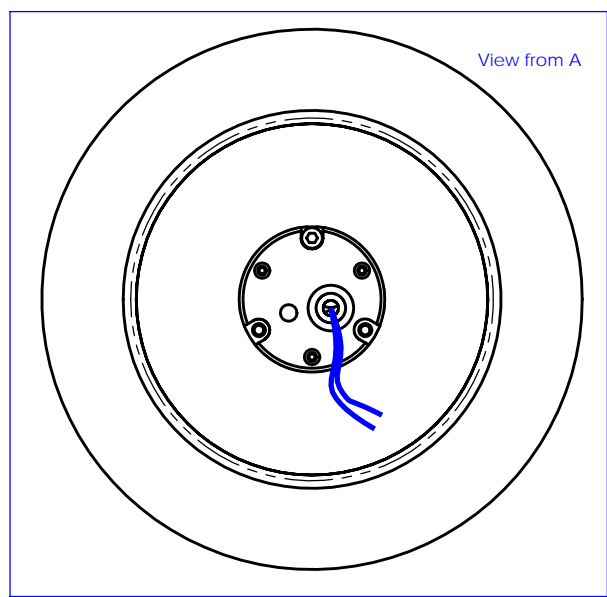
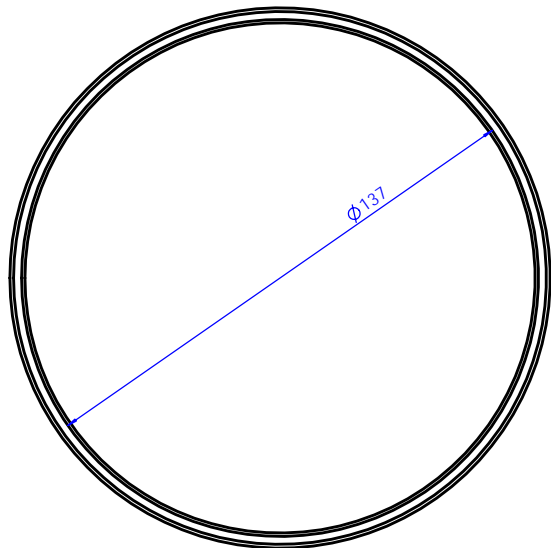
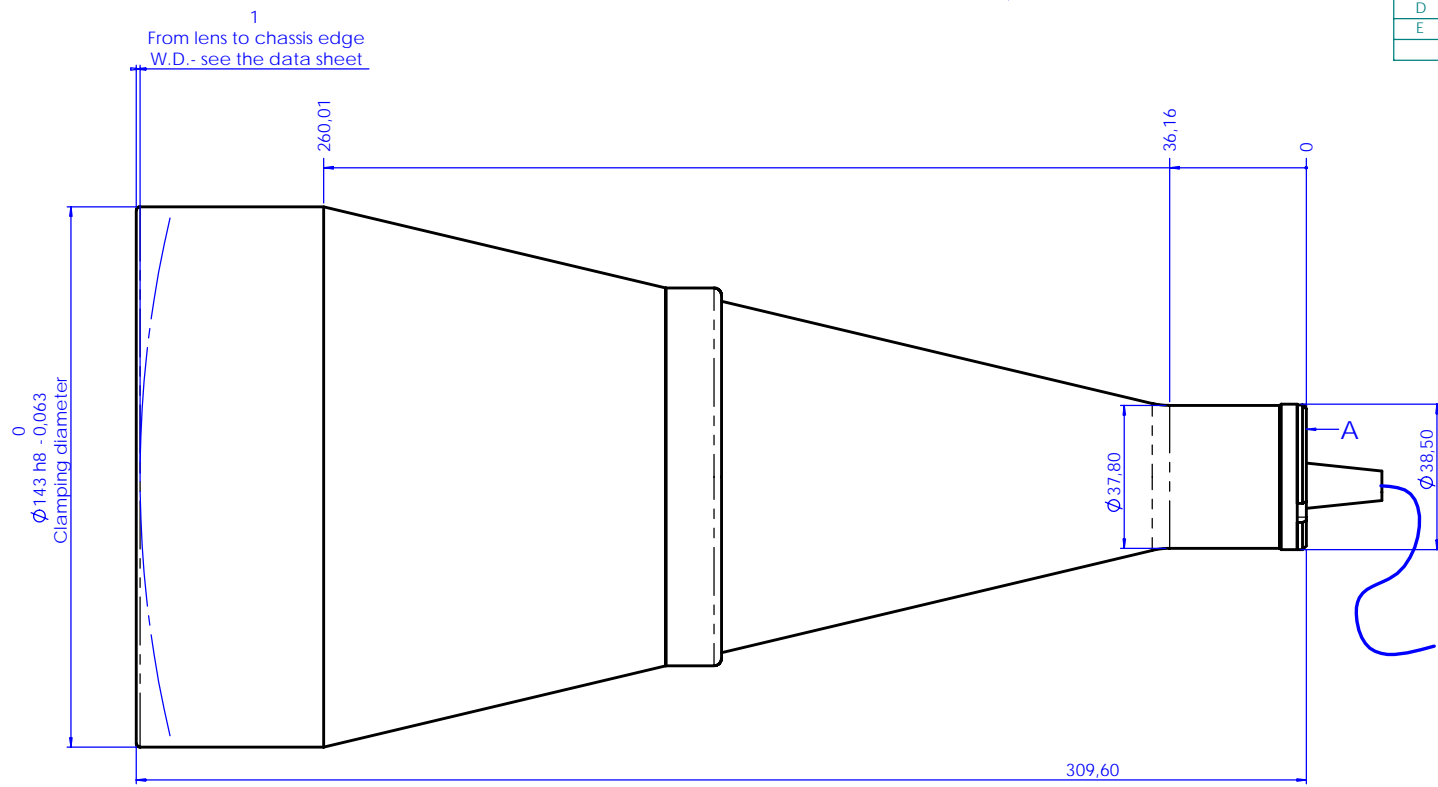

Material	N.A.	Mass	2.3 kg	Scale	1:1
Surface treatment	N.A.	Project-Prod.Item/Instrument	LT CL 96		
Geometrical tolerance (ISO 2768-2)		Class	K	Undimensioned Bevels	1x45°
Linear tolerance (ISO 2768-2)		Class	m	Undimensioned radii	R 0.5
0.5	>3-	>6-	>30-	>120	>400-
-3	-6	-30	-120	-400	-1000
+0.1	+0.1	+0.2	+0.3	+0.5	+0.8
					+1.2
Date		Name		Drawing No.	
Designed 10/05/08		A.Vismara		01278-0-E	
Draw 10/05/08		A.Vismara		Sheet 1/1	
Checked x		C.Sedazzari		Reproduction forbidden without specific authorization	
www.opto-engineering.com					
OPTO ENGINEERING S.r.l. - 46100 Mantova Italy - Via Cremona, 29/2 - Tel. +39 0376 263525 - e-mail info@opto-engineering.com - http://www.opto-engineering.com					