

**FT0532-0250**

250mm, 532 nm  
Fiber Laser F-Theta Lens



part number		FT0532-0250
<b>Wavelength Range</b>	(nm)	532 +/- 30
<b>Focal Length</b>	(mm)	250,0
<b>Back Focal Length</b>	(mm)	290,0
<b>Flange Focal Length</b>	(mm)	355,6
<b>Diagonal Scan Angle</b>	(deg)	57,0
<b>Diagonal Scan Field</b>	(mm)	248,7
<b>Maximum Scan Area</b>	(mm <sup>2</sup> )	175,9 x 175,9
<b>Entrance Beam Diameter</b>	(mm)	20
<b>Mirrors Distance (m1)</b>	(mm)	24,0
<b>2nd mirror Distance (m2)</b>	(mm)	15,7
<b>1/e<sup>2</sup> Spot Radius</b>	(micron)	10
<b>Mounting Thread</b>		M85x1
<b>Length</b>	(mm)	81,8
<b>Outer Diameter</b>	(mm)	128,0
<b>Protective Window</b>		Yes

Rev No.	Description	Date	Name
A	First light	13/07/08	A.Vismara

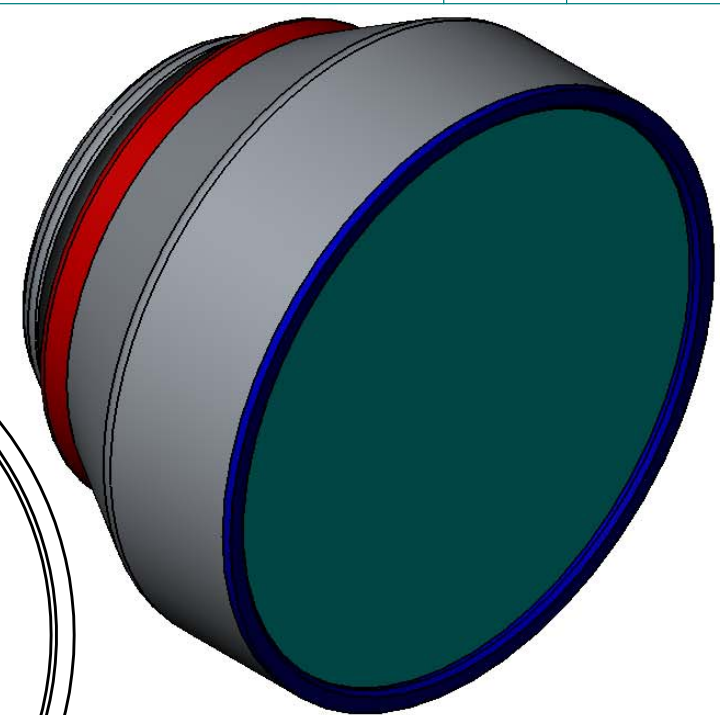
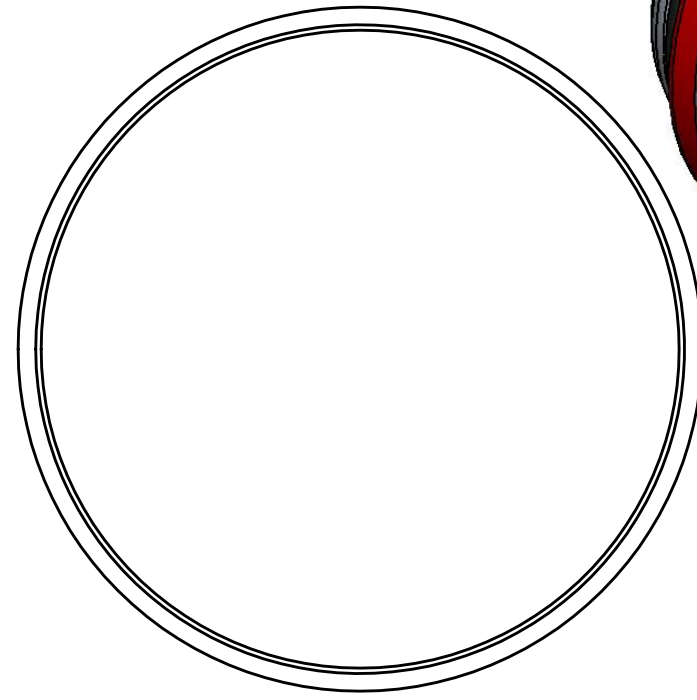
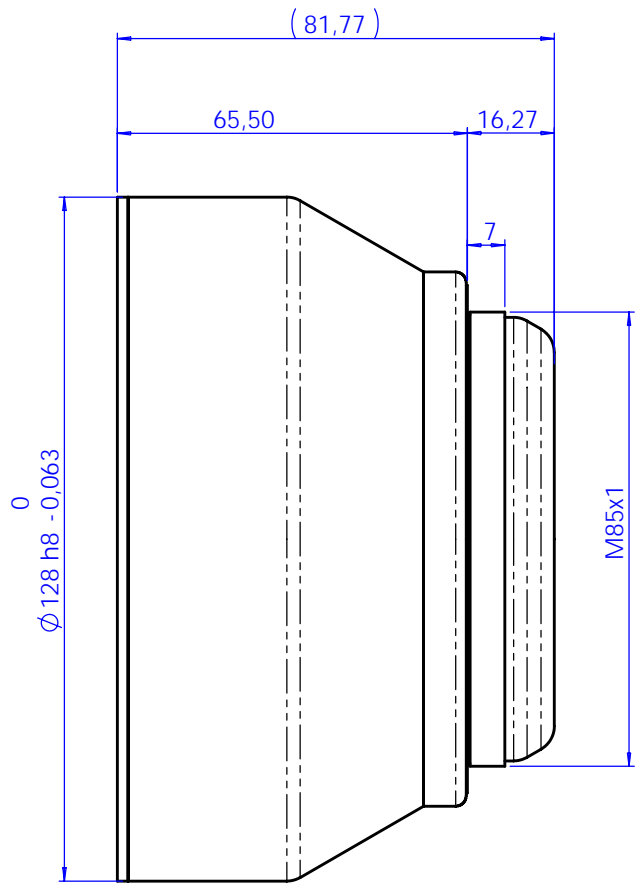

Material	N.A.		Mass	1.38 kg	Scale	1:1	
Surface treatment	N.A.		Project-Prod.Item/Instrument			F-theta	
Geometrical tolerance (ISO 2768-2)		Class	K	Undimensioned bevels	1x45°	Description LAYOUT OF F-THETA 250mm, 532 nm	
Linear tolerance (ISO 2768-2)		Class	m	Undimensioned radii	R 0.5		
0.5 +3 ±0.1	>3- 6 ±0.1	>6- 30 ±0.2	>30- 120 ±0.3	>120 +400 ±0.5	>400- 1000 ±0.8	>1000 +2000 ±1.2	>2000 +4000 ±2
		Date	Name	Drawing No.	Sheet		
		Designed	13/07/08	A.Vismara	DD00014-A	1/1	
		Draw	13/07/08	A.Vismara			
		Checked	X	C. Sedazzari			
<i>Reproduction forbidden without specific authorization</i>							