

CMPT04-09

Optical Plate For 04/09-Type Telecentric Optics

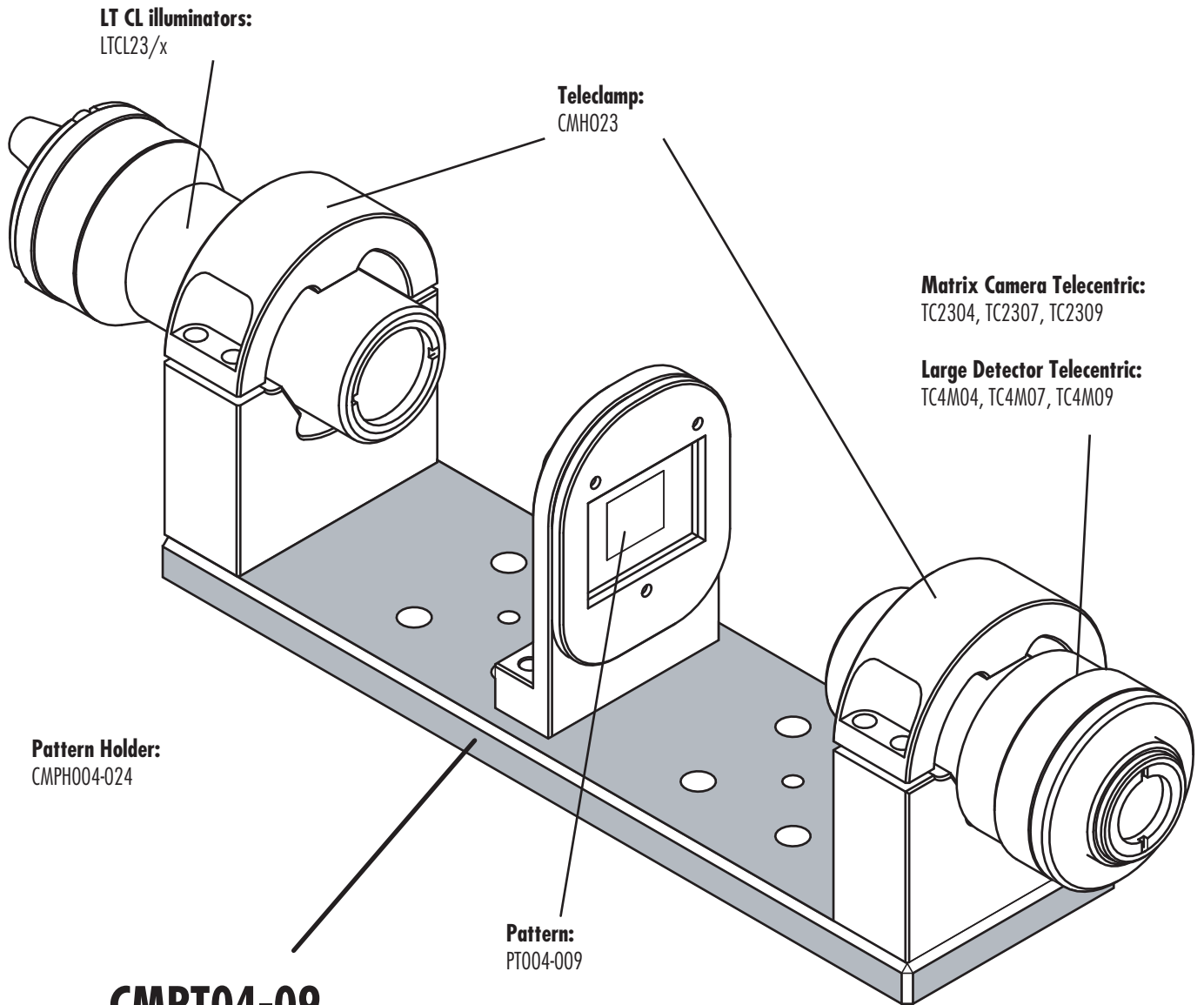

CMPT04-09

part number		CMPT04-09
Compatible CMHO mechanics		CMH023
Compatible Pattern mounts		CMPH004-024
Length	(mm)	199,6
Width	(mm)	56,0
Thickness	(mm)	10,0
Weight	(g)	286

Rev No.	Description
A	New Part

199,60

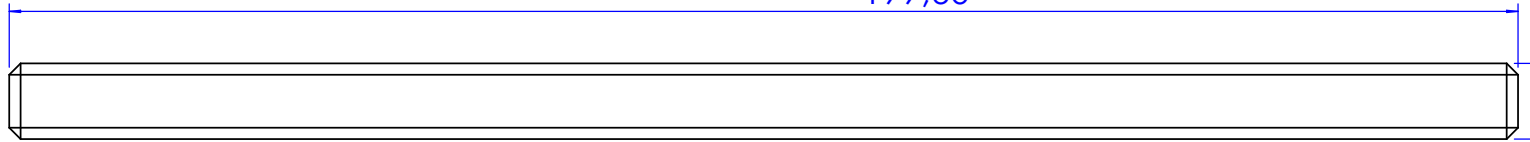

through all holes for M6 screws

Ø 4 F6 through all dowelling holes

Ø 4 F6 dowelling holes for CMPH23

counterbored for M4 screws holes for CMHO23

dowelling for CMHO23

screwed M4 holes for CMPH23

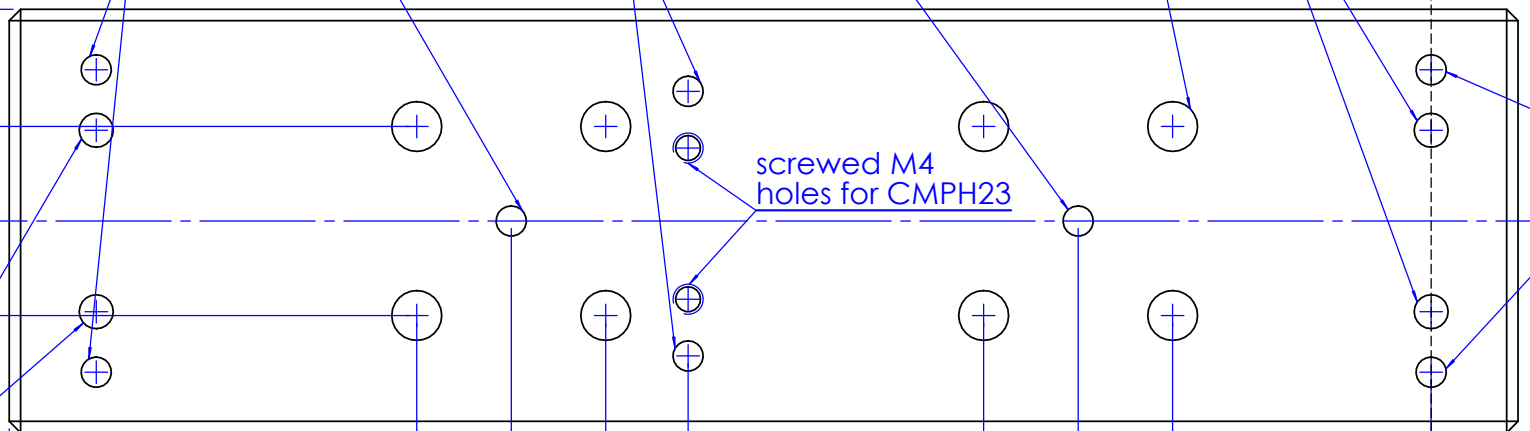

66,40

12,50

0

12,50

23,40

62,50

75

87,50

121,70

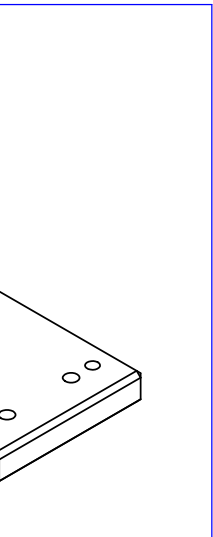

Material Aluminum - UNI EN 573 EN AW 6063		Surface treatment Gray Condensed Anodization		
Geometrical tolerance (ISO 2768-2)			Class	K
Linear tolerance (ISO 2768-2)			Class	m
0,5	>3±	>6±	>30±	>120
±3	6	30	120	±400
±0,1	±0,1	±0,2	±0,3	±0,5
				±0,8
				±1,2
				±2
Date		Undimensioned bevels		
Designed	16/09/09	Undimensioned radii		
Draw	16/09/09	Date		
Checked	X	Designed		
www.opto-engineering.com		Draw		
OPTO ENGINEERING S.r.l. - 46100 Mantova Italy - Via Cremona, 29/2- Tel. +39 0376 263		Checked		